

Being known as the West half (1/2) of Lot No. 25 and the West half (1/2) of Lot No. 26 and the East one-third (1/3) of Lot No. 44 and the East one-third (1/3) of Lot No. 43 of South Montpelier Addition, Vol. 1 Pg. 7, being a part of the Northwest Qtr. (1/4) of Section 11, Township 7 North, Range 2 East, Village of Montpelier, Superior Township, Williams County, Ohio.

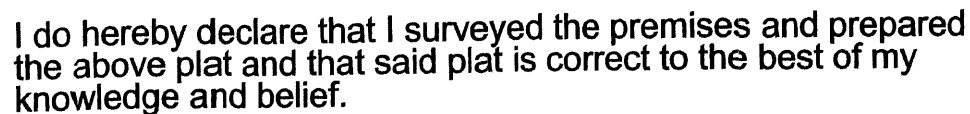

All dimensions are shown in feet and decimal parts thereof. This survey has been recorded in Volume Page , of the Williams County Record of Surveys. 10V 235

A- Capped iron pin found.
B- 5/8" iron pin found.
C- 5/8" capped iron pin set.

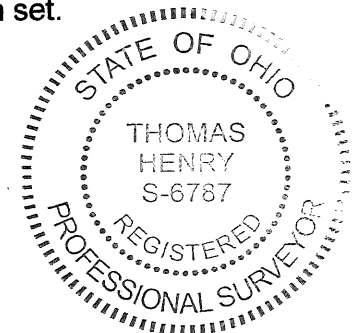

Thomas J Henry, Registered Surveyor No. 6787